

# 2121 / 2121CP / 2121R

## FULL BORE BALL VALVES PN30 FOR MANIFOLD THREAD ISO 228

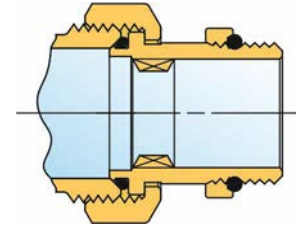
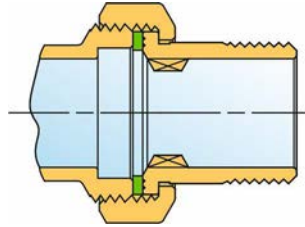
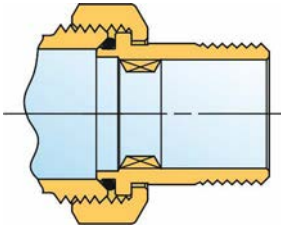

**2121**

**2121CP**

**2121R**

### DESCRIPTION

Suitable for domestic and commercial plumbing, industrial and agricultural applications, heating and sanitary systems, pneumatic systems, oils, generally with every non aggressive fluid.

### PRODUCTION RANGE

Art.	Code	Connection unions	Type
2121	212 0003	1/2"	Red T handle
	212 0001	3/4"	
	212 0002	1"	
	212 0004	1"1/4	
2121R	212 0060	1/2"	Blue T handle
	212 0063	3/4"	
	212 0064	1"	
	212 0065	1"1/4	

Art.	Code	Connection unions	Type
2121CP	212 0025	½"	Red T handle
	212 0021	¾"	
	212 0015	1"	
	212 0024	1"1/4	
	212 0122	1"1/2	
	212 0062	½"	Blue T handle
	212 0125	¾"	
	212 0177	1"	
	212 0140	1"1/4	

Art.	Code	Connection unions	Type
2121R	212 0155	½"	Red T handle
	212 0017	¾"	
	212 0013	1"	
	212 0027	1"1/4	
	212 0156	½"	
	212 0020	¾"	Blue T handle
	212 0014	1"	
	212 0028	1"1/4	

#### MANUFACTURING SPECIFICATIONS

- Body and Sleeve: Brass CW617N nickel finish
- Ball: Brass CW617N chrome plated
- Stem: Brass CW617N
- Tail and nut: Brass CW617N nickel finish
- Side washers: PTFE
- O-rings: Nitrile rubber NBR
- Flat gasket: Fiber
- Butterfly: Red/blue painted aluminum
- Nut: Galvanized steel
- Threads: ISO 228

#### TECHNICAL SPECIFICATIONS

- Maximum working temperature: + 120 °C
- Min working temperature: - 20 °C (provided that the fluid remains in liquid phase)
- Maximum working pressure: See dimensional table (PN)
- Compatible fluids: Water, water and glycol solutions (maximum glycol 30%), non-corrosive fluids \*

\* to check compatibility with fluids or other substances not listed, contact Tiemme technical office.

**DIMENSIONAL SPECIFICATIONS**

**2121-2121CP**

Dimensions en mm

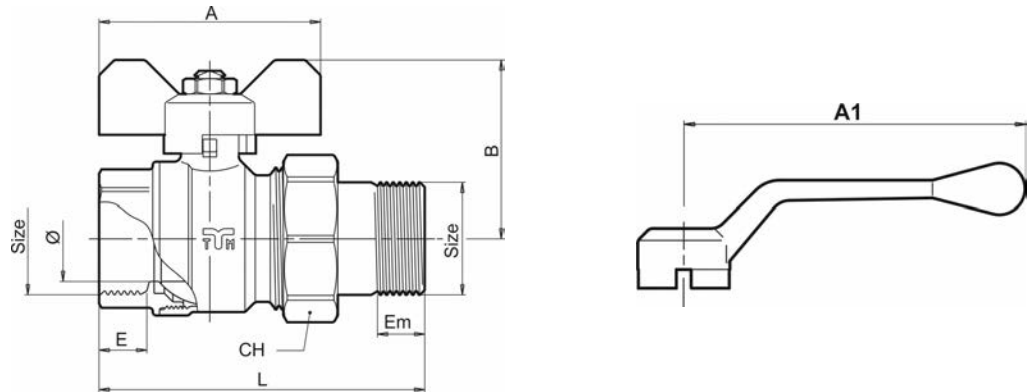

Art.	2120003	2120001	2120002	2120004	
2121	2120060	2120063	2120064	2120065	
Art.	2120025	2120021	2120015	2120024	2120122
2121CP	2120062	2120125	2120177	2120140	
Size	1/2"	3/4"	1"	1 1/4"	1 1/2"
Ø (DN)	15	20	25	32	40
A	50	50	65	65	-
A1	-	-	-	-	140
B	40	43,5	52,5	57,5	79
CH	30	37	46	52	66
E	13,5	14,5	14	15	15
Em	10	12	14	15	16
L	72,5	83	95,5	111,5	123
PN	30	30	30	25	25
PN *	20	20	20	20	20

\* pneumatic systems

**2221R**

Dimensions en mm

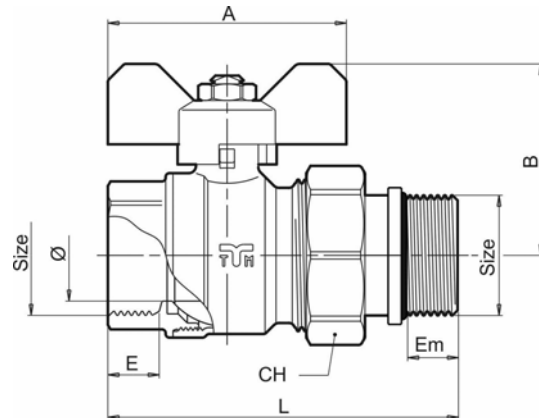

Art.	2120155	2120017	2120013	2120027
2121R	2120156	2120020	2120014	2120028
Size	1/2"	3/4"	1"	1 1/4"
Ø (DN)	15	20	25	32
A	50	50	65	65
B	40	43,5	52,5	57,5
CH	30	37	46	52
E	13,5	14,5	14	15
Em	10	12	14	15
L	72,5	83	95,5	111,5
PN	30	30	30	25
PN *	20	20	20	20

\* pneumatic systems

**HYDRAULIC SPECIFICATIONS**

Diagram 1: Flow/pressure drop.

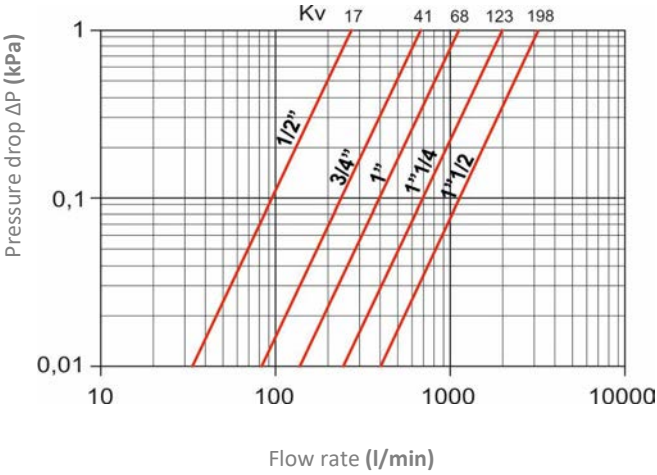
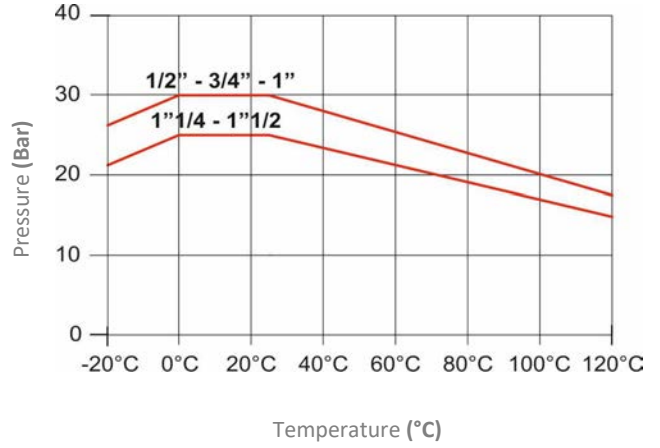

Diagram 2: Pressure/temperature.



**INSTALLATION**

- The valves can be installed in any position (orizental, vertical, ...) provided that shall be placed in visible and accessible position and the open/close operations shall be easily and completely done.
  - Otherwise stated to close the valve the handle shall be turned clockwise, counterclockwise to open it.
  - Otherwise stated by specific marks on the valve body (arrows,...) there is no valve flow direction.
  - The system shall be designed and realised in order to avoid any stress that could damage the valve and could compromise the sealing and the correct working of the valve.
  - All installation operations shall be done using properly tooling. The tightenings shall be such as to guarantee the sealing but without make any damage to the valve or fittings.
  - Once the installation have been completed is necessary to verify the sealings according to technical specifications and/or what required by the country of installation.
  - The valve should not be kept in intermediate position for a long period of time in order to avoid any damages of the valve sealings.
  - If the valve have not been used for a long period of time it may be difficult to operate therefore it will be necessary to use a "long lever".
  - To kept the valve and sealings in good conditions it is suggested to place a filter upstream in order to stop impurity.
- For any further information please contact the authorized dealers or directly TIEMME RACCORDERIE S.p.A.

*TIEMME RACCORDERIE S.p.A. declines all responsibility in case of failures and/or accidents resulting from the non-compliance with these indications and from improper use of the system. The information given does not exempt the user from following the regulations and good technical regulations in force.*

**CERTIFICATIONS**

